

# Butterfly Backpack

## Product Parts

- 1 - Banner Rod (x6)
- 2 - Backpack
- 3 - Graphic (x2)

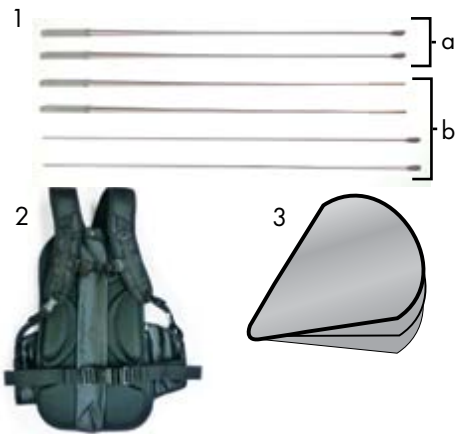

## Set-up Instructions

### Step 1

Remove all of the parts from package and set them, along with your graphic, on a flat, clean surface.

### Step 2

Connect (b) rod ends together to form one pole.



### Step 3

Insert ends of the rods(1) into the black pole pockets of the butterfly graphic(3). Short rods (a) go into bottom pole pockets, while longer rods (b) go into top pole pockets.

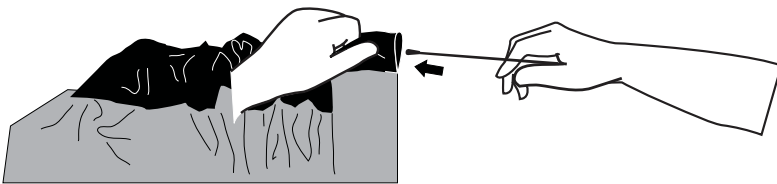

### Step 4

Insert the base of the rods(1) into the opposing corner slots on the back of the backpack(2). Short rods go into bottom slots, while longer rods go into top slots to create butterfly shape.



### Step 5

Secure Backpack to your person.

## Storage & Care

Place all poles into the zippered section of the backpack and place the graphic into the outside pouch into the backpack. Clean backpack with damp cloth and wipe dry. Spot Clean graphics with dry cloth.

*Warranty Information: All products are designed to provide the user with a cost-effective and durable product. Standard warranty is a 'one year parts and labor' warranty which warrants product against defects in material and workmanship. It does not cover damage due to accidents, abuse, or normal wear and tear. Products found to be defective will be replaced or repaired at factory's discretion.*